

BUILDING	BUILDING INFORMATION				
	1	2	3	4	5
TYPE OF CONSTRUCTION	1S	2N	2	3	4
USE GROUP	B2	B2	B2	B2	B2
NO. STORIES	4	4	4	4	4
BUILDING HEIGHT	57.4'	54.3'	54.9'	53.4'	55.7'
BUILDING FOOTPRINT AREA	17,472 sq ft	16,588 sq ft	16,588 sq ft	16,884 sq ft	16,100 sq ft
BUILDING GROSS FLOOR AREA	52,028 sq ft	40,648 sq ft	52,500 sq ft	45,128 sq ft	47,072 sq ft
MECHANICAL SEPARATION WALLS	4943 sq ft	3776 sq ft	2113 sq ft	4193 sq ft	4806 sq ft
MECHANICAL SEPARATION WALLS	0	0	0	0	0
FIRST FLOOR	124.01	124.01	124.01	124.01	124.01
GARAGE	120.45	120.45	120.45	120.45	120.45
SPRINKLERED	YES	YES	YES	YES	YES

REPORT NUMBER	DATE	BY	FOR
100-2-187	08-2-187	JMS	100-2-187
100-2-188	08-2-187	JMS	100-2-188
100-2-189	08-2-187	JMS	100-2-189
100-2-190	08-2-187	JMS	100-2-190
100-2-191	08-2-187	JMS	100-2-191
100-2-192	08-2-187	JMS	100-2-192
100-2-193	08-2-187	JMS	100-2-193
100-2-194	08-2-187	JMS	100-2-194
100-2-195	08-2-187	JMS	100-2-195
100-2-196	08-2-187	JMS	100-2-196
100-2-197	08-2-187	JMS	100-2-197
100-2-198	08-2-187	JMS	100-2-198
100-2-199	08-2-187	JMS	100-2-199
100-2-200	08-2-187	JMS	100-2-200

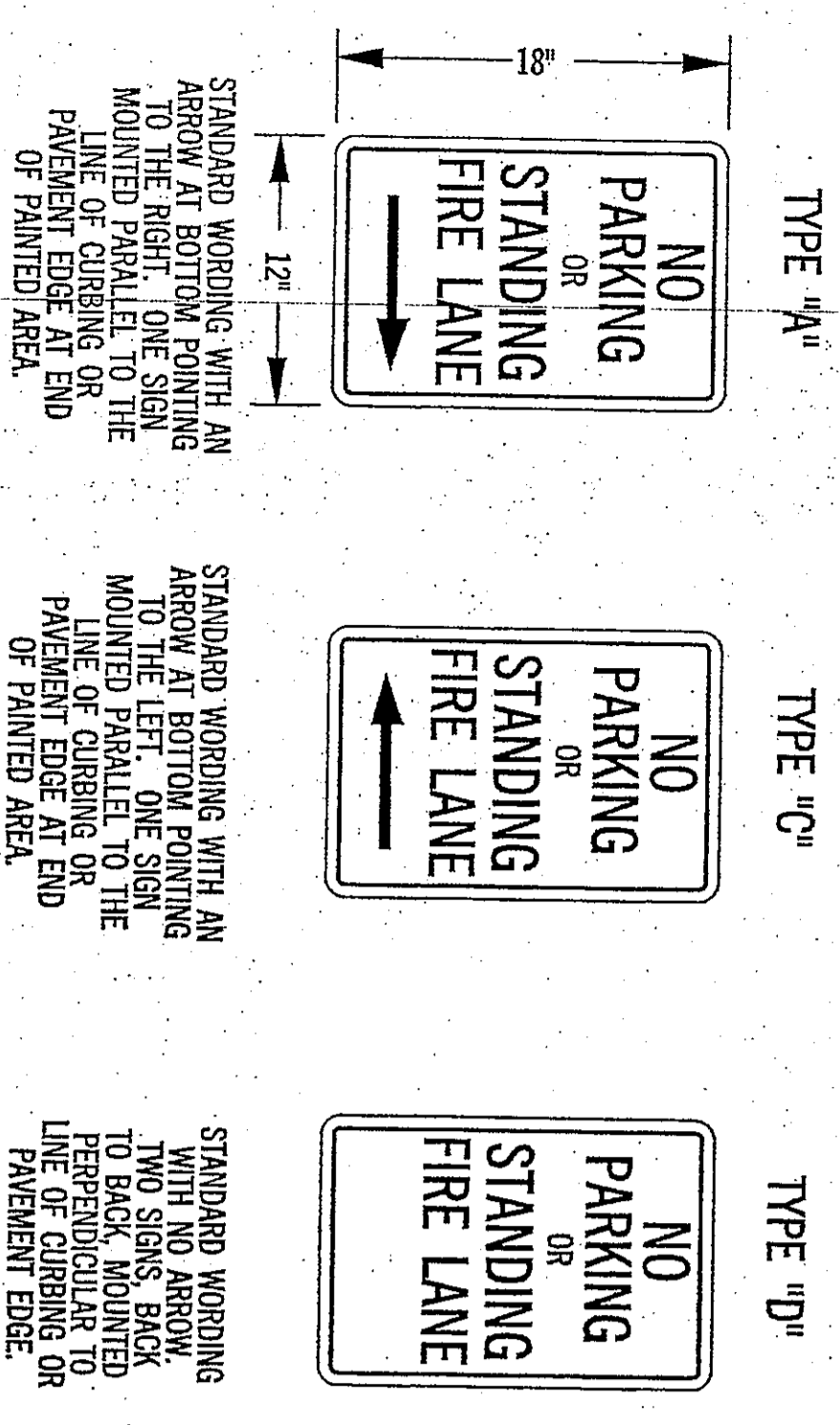

**FIRE LANE SIGN DETAILS**  
NOT TO SCALE

- KEY:**
- ..... PAINTED CURB (YELLOW)
  - A TYPE 'A' SIGN (DIRECTIONAL ARROW POINTING TO THE RIGHT)
  - C TYPE 'C' SIGN (DIRECTIONAL ARROW POINTING TO THE LEFT)
  - D TYPE 'D' SIGN (DOUBLE FACE SIGN-REQUIRED BETWEEN 'A' & 'C')

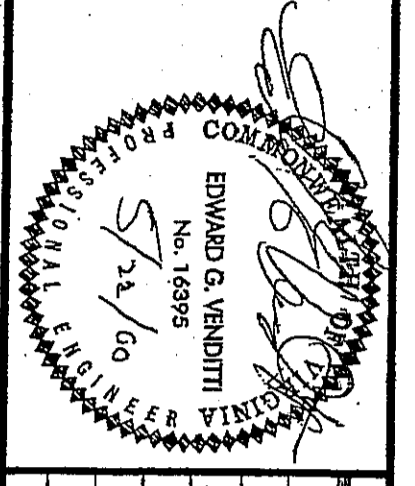

NO.	REVISION	DATE	BY

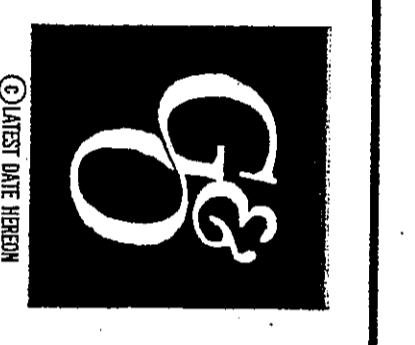

**Greenhome & O'Mara, Inc.**  
11211 WAPLES MILL ROAD  
FAIRFAX VIRGINIA 22030  
(703) 385-9800

**FIRELANE PLAN**  
**METRO PLACE AT DUNN LORING**  
PARCEL L (PREVIOUSLY PARCEL C-1)

DESIGN	SCALE
SLM SLM DRAWN	1:500
EGV CHECKED	20 OF 35
DATE	5/16/99
SHEET	PP-805
PROJ. NO.	51691ADE
FILE NO.	PP-805

**FIRE LANE NOTE:**  
FIRE MARSHAL FIELD INSPECTION NECESSARY FOR FINAL APPROVAL OF FIRE LANES. FIRE LANES MUST HAVE FINAL APPROVAL PRIOR TO REQUEST FOR OCCUPANCY. OWNERS SHALL NOTIFY FAIRFAX COUNTY FIRE AND ALARM BUREAU OF THE LOCATION AND NUMBER OF FIRE LANES. FIRE LANES SHALL BE INSTALLED ON 3RD FLOOR. FIRE LANES HAVE BEEN INSTALLED.

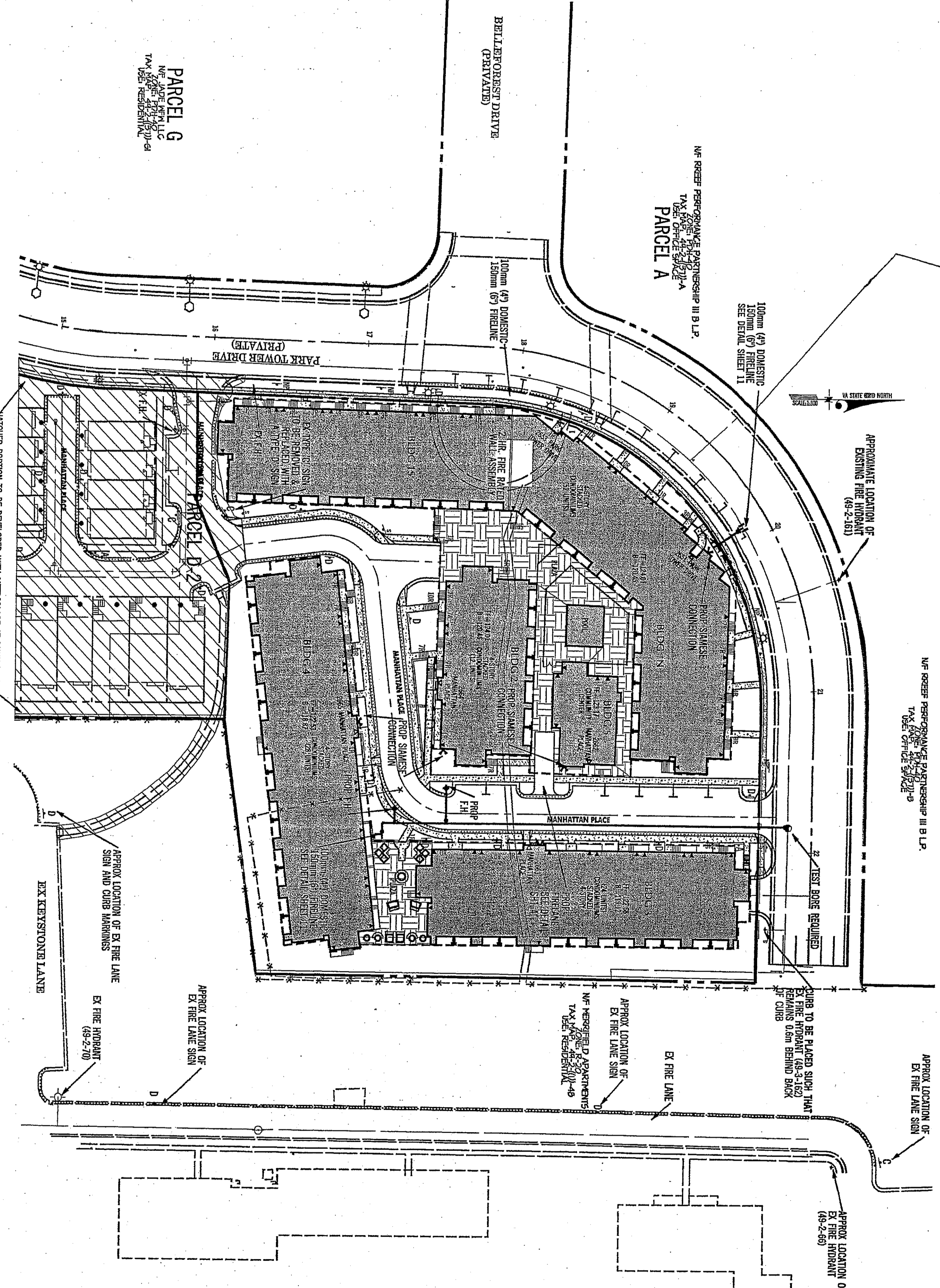

**FIRE LANE DESIGNATIONS**

UNDER SECTION F313.0 OF THE FAIRFAX COUNTY FIRE PREVENTION CODE, THE FIRE PREVENTION DIVISION IS AUTHORIZED TO DESIGNATE FIRE LANES ON PUBLIC STREETS AND ON PRIVATE PROPERTY WHERE NECESSARY. THIS IS TO PREVENT PARKING IN FRONT OF OR ADJACENT TO FIRE HYDRANTS AND TO PROVIDE ACCESS FOR FIRE FIGHTING EQUIPMENT. MARKINGS AND SIGNS ARE TO BE PROVIDED BY OWNER OR AGENT OF THE PROPERTY INVOLVED. PARKING OR OTHERWISE OBSTRUCTING SUCH AREAS IS PROHIBITED.

ENFORCEMENT OF THIS SECTION, POLICY WILL BE AS FOLLOWS:

- I. HYDRANTS
  - A. PARKING IS PROHIBITED WITHIN 4.6 M OF A FIRE HYDRANT LOCATED ALONG THE CURB LINE OR EDGE OF ANY PUBLIC OR PRIVATE ROADWAY. NO SPECIAL CURB MARKING IS REQUIRED FOR ENFORCEMENT.
  - B. FIRE HYDRANTS INSTALLED IN PARKING LOTS ARE TO BE LOCATED WITHIN A FIRE LANE. CURB AND/OR ROADWAY MARKING IS REQUIRED IN ACCORDANCE WITH SECTIONS III AND IV BELOW.
- II. FIRE LANES
  - A. FIRE LANES SHALL BE INSTALLED WHERE REQUIRED BY THE OFFICE OF THE FIRE MARSHAL. FIRE LANES SHALL BE MARKED WITH BOTH SIGN AND CURB DELINEATION PER SECTION III AND IV BELOW. PARKING AND TRAFFIC FLOW PATTERNS SHALL BE REQUIRED AS FOLLOWS:

**STANDARD REQUIREMENTS**

STREET WIDTH	ONE-WAY TRAFFIC	TWO-WAY TRAFFIC
CURB TO CURB	TRAFFIC	TRAFFIC
7.2m to 8.7m	PARALLEL PARKING ON ONE SIDE AS DECIDED BY FAIRFAX COUNTY OFFICE OF THE FIRE MARSHAL	NO PARALLEL PARKING ON EITHER SIDE OF STREET
9m to 10.5m	PARALLEL PARKING ALLOWED ON BOTH SIDES OF THE STREET	PARALLEL PARKING ON ONE SIDE AS DECIDED BY FAIRFAX COUNTY OFFICE OF THE FIRE MARSHAL
10.8m or GREATER	PARALLEL PARKING ALLOWED ON BOTH SIDES OF THE STREET	PARALLEL PARKING ALLOWED ON BOTH SIDES OF THE STREET

**III. SIGN SPECIFICATIONS**

- A. METAL CONSTRUCTION, 12" X 18".
- B. RED LETTERS ON REFLECTIVE WHITE BACKGROUND WITH 1/2" RED TRIM STRIP AROUND ENTIRE OUTER EDGE OF SIGN.
- C. LETTERING ON SIGN TO BE "NO PARKING OR STANDING FIRE LANE".
- D. LETTERING SIZE TO BE AS FOLLOWS: "NO PARKING AND STANDING" 30mm, OR " " IS 25mm, "FIRE LANE" IS 38mm AND THE ARROW WITH THE SOLID SHAFT IS 25mm X 150mm WITH THE SOLID HEAD 30mm WIDE AND 30mm DEEP.
- E. SIGNS ARE TO BE MOUNTED 2.1m FROM THE GROUND TO THE BOTTOM OF THE SIGN UNLESS OTHERWISE DIRECTED BY THE OFFICE OF THE FIRE MARSHAL.
- F. POSTS FOR SIGNS WHEN REQUIRED, SHALL BE METAL AND SECURELY MOUNTED, UNLESS WRITTEN PERMISSION FOR ALTERNATIVES IS OBTAINED FROM THE INSTALLATION FROM THE OFFICE OF THE FIRE MARSHAL. SIGNS SHOULD BE SPACED AS ON APPROVED PLANS. IN LONG STRETCHES, THE MAXIMUM DISTANCE BETWEEN SIGNS IS 21m.
- G. OTHER SPECIAL SIGNS AS APPROVED BY THE OFFICE OF THE FIRE MARSHAL.

**IV. CURB DESIGNATION**

- A. ALL CURBS OR PAVED SPACES DESIGNATED AS FIRE LANES SHALL BE INDICATED BY YELLOW PAINT AS APPROVED BY THE OFFICE OF THE FIRE MARSHAL. IN AREAS WITHOUT CURBING, A 150mm WIDE YELLOW STRIPE SHALL BE APPLIED TO THE EDGE OF THE PAVEMENT. PAINT SHALL BE HIGHWAY TRAFFIC GRADE.